

3 BARLEY CLOSE EARDISLEY HEREFORD HR3 6PQ

PRICES FROM: **£495,000**

FREEHOLD

An exceptional small development of just five individual homes, set within a highly sought-after village location.

A choice of three beautifully designed detached dormer bungalows, offering versatile 3/4 bedroom accommodation with light, spacious interiors and quality finishes throughout.

Perfect for families or those looking to downsize without compromise, these stylish new homes provide flexible living space, private gardens, and driveway parking.

Prices from £495,000 – early viewing highly recommended.

Ground Floor

Approx. 99.5 sq. metres (1071.5 sq. feet)

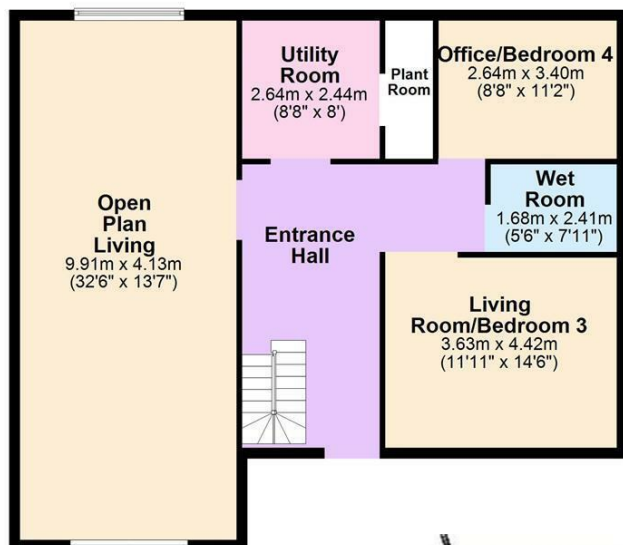

First Floor

Approx. 59.5 sq. metres (640.3 sq. feet)

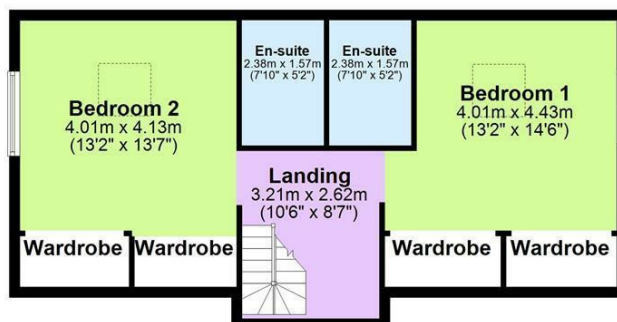

EPC Rating: **Council Tax Band: New Build**

Agents Note: Whilst every care has been taken to prepare these particulars, they are for guidance purposes only. All measurements are approximate and are for general guidance purposes only and whilst every care has been taken to ensure their accuracy, they should not be relied upon and potential buyers/tenants are advised to recheck the measurements

Flint and Cook Hereford Sales 01432 355455

22 Broad Street
Hereford
Herefordshire
HR4 9AP

hereford@flintandcook.co.uk
flintandcook.co.uk

